

A-54-41-42

1824-43-289

D-9-155

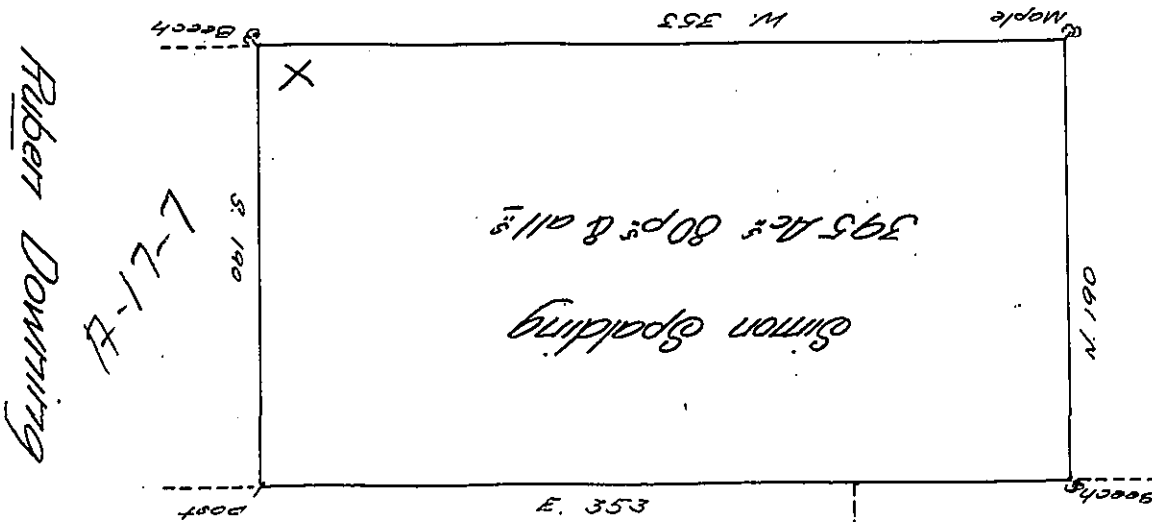

A-17-7

A-65-196

PAGE - 192
Lucy Starling

By Virtue of a Warrant dated Aug^t 20th 1792 Surveyed
the 8th of October 1793 unto Simon Spalding the above
described Tract of Three hundred and ninety five Acres
and 80 perches of Land and Allow. Situated among
the westerly branches of Sugar Creek in Luzerne County

By Wm. Montgomery D.S.

Jo. J. Wallis D.S.

To Daniel Brodhead Esq.
Surv^r. Gen^l. of Penn^a.

22

IN TESTIMONY that the above is a copy of the original remaining on file in
the Department of Internal Affairs of Pennsylvania, made
comformably to an Act of Assembly approved the 16th day of
February 1833, I have hereunto set my hand and caused
the Seal of said Department to be affixed at Harrisburg,
this twenty-third day of January 1907

Isaac D. Brown

Secretary of Internal Affairs.